

A classic form with die cast aluminium lamp housing. FREDA is an ultra-efficient LED spotlight for display lighting applications. Available in a wide range of lumen outputs and with interchangeable optics the FREDA has been designed to optimise CASAMBI wireless dimming technology via its specially engineered control housing.

**Applications:**

- Retail
- Architectural
- Commercial
- Exhibition

**Accessories:**

- Interchangeable optics

**Technical features:**

- 95% Reflector efficiency
- Light Output Ratio 90%
- Power Factor min 0.90
- Up to 136 lumens per watt
- Die-cast Aluminium. PPC coated
- L80B10
- Up to 98 CRI available (special order only)

**Refer to table below for exact lumen output:**

(all lumens are exit lumens)

CRI CCT	Luminaire output Lumens and (Efficiency in Luminaire Lumen Per Watts) at typical drive current (mA) and forward voltage (V) DC							
	350mA 31V		500mA 31.7V		600mA 32.1V		700mA 32.5V	
	LED watts	Total watts	LED watts	Total watts	LED watts	Total watts	LED watts	Total watts
	10.8	12.9	15.8	18.3	19.3	22.2	22.8	26.2
827	1598 (124)		2146 (117)		2548 (115)		2900 (111)	
927	1318 (102)		1770 (97)		2102 (95)		2392 (91)	
830	1698 (132)		2280 (125)		2707 (122)		3081 (118)	
835	1738 (135)		2334 (128)		2771 (125)		3154 (120)	
930	1378 (107)		1851 (101)		2197 (99)		2501 (95)	
840	1748 (136)		2347 (128)		2787 (126)		3172 (121)	
Lumen Class	1500		2000		2500		3000	

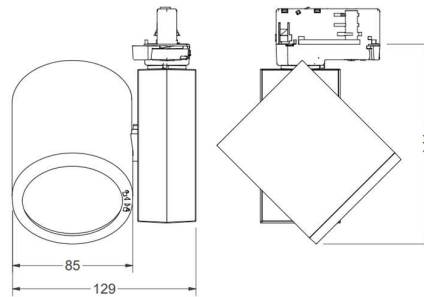

Total weight: 1.5Kg MAX

**Part number nomenclature and examples:**

Part Number	Description
FRT3B3V1500N830W	FREDA:TRK3CKT:B3V:1500LM: NAR-BEAM:3K80CRI:WHITE
FRT3B3V3000M930B	FREDA: TRK3CKT:B3V:3000LM: MED-BEAM:3K90CRI: BLACK

FR = FREDA Family

T1 = Track mounted - single circuit

T3 = Track mounted - triple circuit

B3V = LED Technology

1500 = 1500 Lumen\* output (Based on 830)

2000 = 2000 Lumen\* output (Based on 830)

2500 = 2500 Lumen\* output (Based on 830)

3000 = 3000 Lumen\* output (Based on 830)

N = Narrow beam 10-20°

M = Medium beam 20-30°

W = Wide beam 30-50°

XW = Extra wide beam >50°

827 = >80CRI 2700K\*\*\*

927 = >90CRI 2700K\*\*\*

830 = >80CRI 3000K\*\*\*

835 = >80CRI 3500K\*\*\*

930 = >90CRI 3000K\*\*\*

840 = >80CRI 4000K\*\*\*

W = RAL9010 Pure White\*\*

G = RAL9006 Grey Silver\*\*

B = RAL9005 Jet Black\*\*

D1 = Dimmable Phase

D2 = Dimmable 1-10V

D3 = Dimmable DALI

D4 = Dimmable CASAMBI

\* Refer to lumen output table for exact lumen output (all lumens are exit lumens).

\*\* Other finishes available to special order.

\*\*\* Other colour options are available on request: please contact our sales team to discuss your requirements.

**Polar curves of reflector options**

